

FOR MORTGAGE LENDER USE ONLY

GENERAL NOTES: (1) DISTANCES SHOWN ARE TAKEN FROM PROVIDED TITLE REFERENCES SHOWN BELOW. (2) THE PURPOSE OF THIS INSPECTION IS TO RENDER AN OPINION AS FOLLOWS: A) DWELLING AND ACCESSORY STRUCTURE'S COMPLIANCE WITH RESPECT TO MUNICIPAL ZONING SETBACKS, AND B) FLOOD ZONE DETERMINATION BY HORIZONTAL SCALING ON BELOW REFERENCED FEMA MAP. (3) THIS INSPECTION EXCEPTS OUT ALL TECHNICAL STANDARDS CURRENTLY SET FORTH BY STATE OF MAINE BOARD OF LICENSURE FOR PROFESSIONAL LAND SURVEYORS. (4) THIS INSPECTION IS TO BE USED ONLY BY THE BELOW LISTED LENDER, TITLE ATTORNEY & TITLE INSURER AND IS NOT TO BE USED BY ANOTHER PARTY FOR BOUNDARY LINE LOCATIONS OR LAND TITLE OPINIONS. (5) A BOUNDARY SURVEY SHOULD BE PERFORMED TO RENDER A PROFESSIONAL OPINION PERTAINING TO BOUNDARY LINE LOCATIONS, EASEMENTS, RIGHTS OF WAY, ENCUMBRANCES, ENCROACHMENTS, AND/OR CONFLICTS WITH ABUTTER'S DEEDS.

REV. 07/13/09

THIS SKETCH IS NOT TO BE USED FOR CONSTRUCTION PURPOSES, IMPROVEMENTS SHOWN ARE APPROXIMATE.

ADDRESS: 571 Allen Avenue
Portland, Maine

INSP. DATE: 07/13/2009

SCALE: 1" = 30'

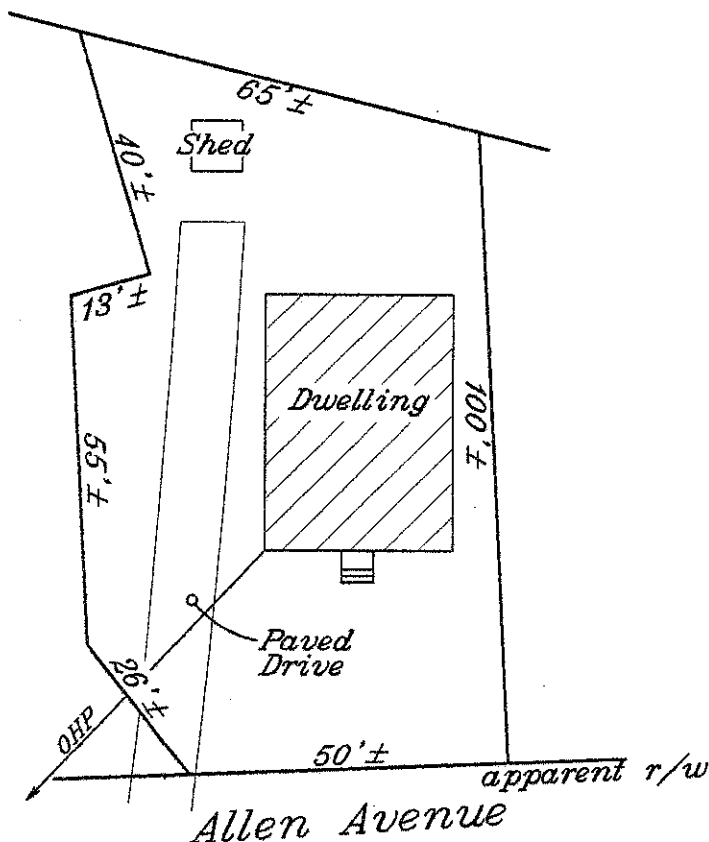

JDN

SEE PROVIDED TITLE REFERENCES FOR APPURTENANCES, IF ANY.

APPLICANT: Tara Hilt FILE#: 20922080

OWNER: Dickhaut & Coggins CLIENT#: TE10088

LENDER: Merrimack Mortgage Company

REQ. PARTY: Fidelity Title Company

ATTORNEY: Thomas Powers

TITLE REFERENCES: COUNTY: Cumberland

DEED BOOK: 24545 PAGE: 32

PLAN BOOK: 17 PAGE: 7 LOT: 1695
p/o 1694

MUNICIPAL REFERENCE:

MAP: 399 BLOCK: E LOT: p/o 2

THE DWELLING DOES NOT FALL WITHIN A SPECIAL FLOOD HAZARD ZONE PER FEMA COMMUNITY MAP No. 230051 PANEL: 0002C
ZONE: C DATE: 12/8/1998

THE DWELLING WAS ☒ IN COMPLIANCE WITH MUNICIPAL ZONING SETBACK REQUIREMENTS AT THE TIME OF CONSTRUCTION.

James D. Nadeau, LLC

Professional Land Surveyors
Certified Floodplain Managers

[Signature]
7-14-09

918 BRIGHTON AVE. PH.(207)878-7870
PORTLAND, ME. 04102 F.(207)878-7871

THIS INSPECTION IS VALID ONLY WITH AN
EMBOSSED SEAL AND IS NULL & VOID
90 DAYS AFTER INSPECTION DATE

THIS IS NOT A BOUNDARY SURVEY - NOT FOR RECORDING